



Rectangular SAW Mount



Rectangular SAW Mount

Rectangular SAW mountings are also known as 'Sandwich' mountings because they feature a rubber section sandwiched between plates of metal.

This arrangement allows a large difference between the compression and shear stiffnesses, thus providing the potential to 'tune' a mounting system by rotating the mountings.

These mountings are commonly installed in a 'Vee' formation to utilize this feature.

The Rectangular SAW Mountings has the following features:

- Available with plate or stud fixings.
- Can be loaded in compression or shear, or a combination of both, for example in a 'Vee' arrangement.
- Can be manufactured with or without interleaves to change the ratio of shear to compression stiffness.

About Trelleborg Industrial AVS

Over 100 years of experience as Metalastik and Novibra, today Trelleborg Industrial AVS make improvements people can physically feel. From smoother travel to quieter, more efficient machines, we make life feel better. With quality, testing and compliance built in, we're in it for the long haul, ensuring your solution still works, over an extended and often arduous life-cycle.

With three state-of-the-art manufacturing plants across the globe, our experience in rubber to metal bonding enhances several industries, including off-highway vehicles, rail and mass transit, marine and energy and general industry.

We offer an end-to-end service, to take you from concept through design, manufacturing and testing to delivery. This reduces the complexity of supply, helping you cut costs, mitigate risk and receive on time, on budget delivery.

Trelleborg IAVS is part of Trelleborg Group, which employs 15,000 people in over 40 countries. Whatever your challenge, whatever your role and wherever you are, we are nearby to offer expert knowledge and quality solutions.

Rectangular SAW Mount

Technical Drawing

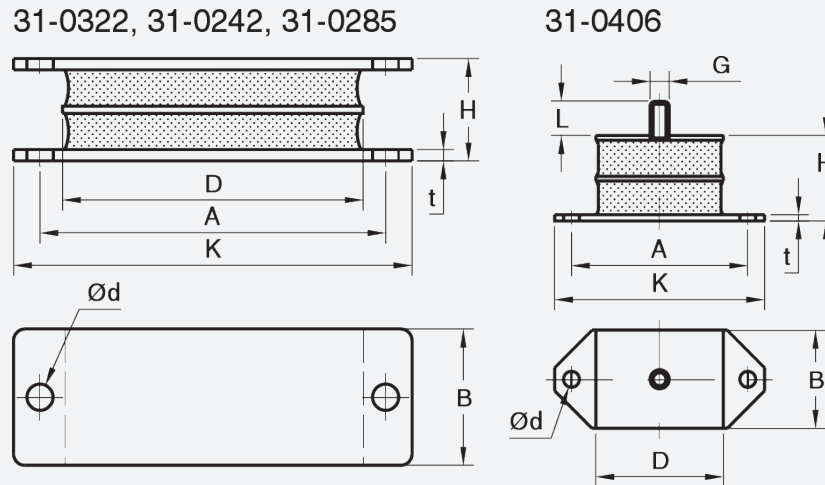

Product Data

DRAWING NO.	PART NO.	DIMENSIONS (MM)									MAX LOAD IN COMPRESSION (KG)	MAX LOAD IN SHEAR (KG)	WEIGHT (KG)
		A	B	K	H	D	d	t	G	L			
31-0322-45	10-00658	89	57	108	43	63.5	11	5			180	50	0.65
31-0322-60	10-00659	89	57	108	43	63.5	11	5			360	75	0.65
31-0242-45	10-00648	146	57	168	43	127	11	5			450	120	1.1
31-0242-60	10-00651	146	57	168	43	127	11	5			900	150	1.1
31-0242-70	10-00652	146	57	168	43	127	11	5			1050	150	1.1
31-0406-45	10-00661	74.5	41	89	36	54	6.5	2.5	M8	14	90	40	0.23
31-0406-60	10-00971	74.5	41	89	36	54	6.5	2.5	M8	14	180	70	0.23
31-0406-70	10-00663	74.5	41	89	36	54	6.5	2.5	M8	14	250	90	0.23
31-0285-45	10-00656	146	57	168	43	127	11	5			275	150	0.9
31-0285-60	10-00657	146	57	168	43	127	11	5			546	150	0.9



WWW.TRELLEBORG.COM/ANTI-VIBRATION-SOLUTIONS

For further information visit our website or e-mail industrialavs@trelleborg.com

The content in this datasheet was correct at the time of printing, but is subject to change without notice.